

RAY-BAR LEAD LINED VISION FRAME

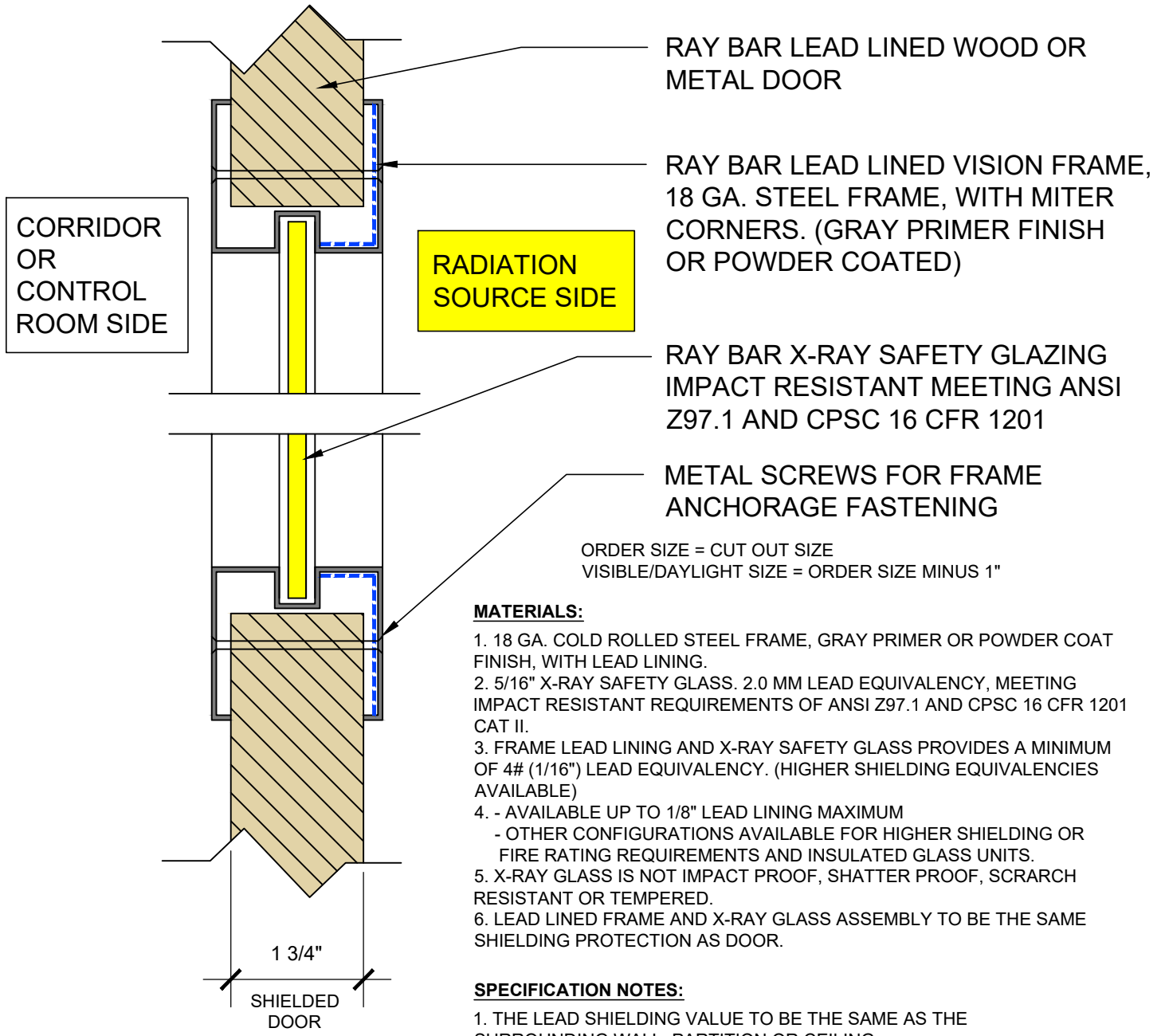

Terms of Use: Certain designs and concepts are the exclusive proprietary property and work product of Ray-Bar Engineering provided in good faith as a courtesy for the architectural design of projects specifying, incorporating and utilizing genuine Ray-Bar products and assemblies. Ray-Bar designs are not to be copied, altered, plagiarized or utilized in any competitive or detrimental manner against Ray-Bar as protected by law and/or copyrights. "All Rights Reserved"



JOB NAME:	
LOCATION:	
ROOM NUMBER:	
SHEET ____ OF ____:	

RAY-BAR LEAD LINED VISION FRAME ASSEMBLY

RAY-BAR ENGINEERING CORP.

Toll Free: 1(800) 444-XRAY / 1(800) 444-9729
Telephone: (626) 969-1818
24 Hour Fax: 1(800) 333-XRAY /
1(800) 333-9729

WWW.RAYBAR.COM

SCALE
6" = 1'-0"
RAY-BAR
LLVF